

fancort Industries, Inc.

31 FAIRFIELD PLACE

WEST CALDWELL, N. J. 07006

(973) 575-0610

WWW.FANCORT.COM

FAX (973) 575-9234

QUAD PACK SPECIFICATION SHEET

FA NUMBER PROPOSED

CUSTOMER _____

PART NUMBER TI 68 CQFP

DATE 5/27/08

DRAWN BY FANCORT BC

CHECKED BY _____

PACKAGE TYPE

TOP BRAZE

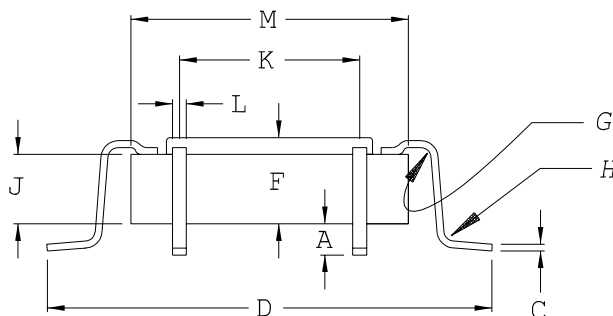

FOOT CONFIGURATIONS

SPRING BACK
ANGLE 3°-7°

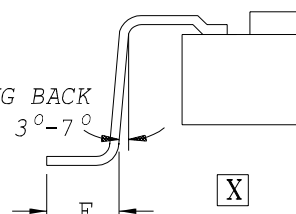

OPTION 1

OPTION 1

OPTION 2

SIDE EXIT

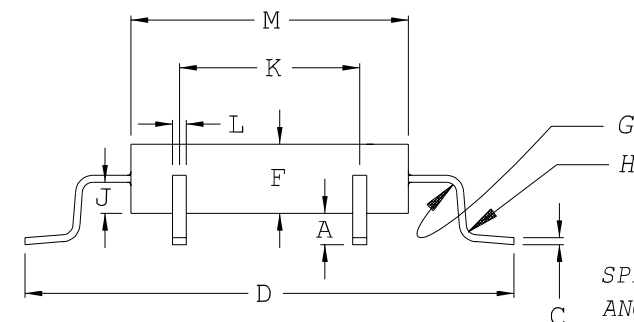

SPRING BACK
ANGLE 3°-7°

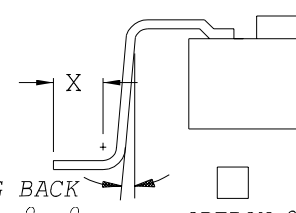

OPTION 2
JEDEC

BOTTOM EXIT

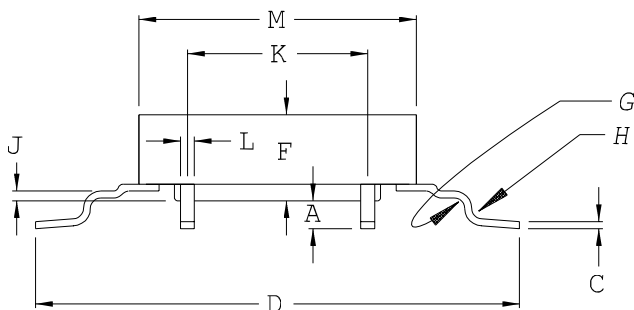

	DIM. X	DIM. Y	TOLERANCE
A	.010	.010	.002
C	.007	.007	MAX
D	.710	.710	.010
E	.050	.050	.005
F	.152	.152	MAX
G	.012	.012	.002
H	.012	.012	.002
J	.064	.064	REF
K	.400	.400	BSC
L	.013	.013	MAX
M	.500	.500	MAX
PITCH	.025	.025	
# OF LEADS PER SIDE	17	17	
TOTAL # OF LEADS	68		

CUSTOMER SIGNATURE &
DATE FOR ACCEPTANCE _____

CONTROLLING UNITS ARE [METRIC] INCHES

LEADS TINNED YES NO LEAD TYPE: FLAT

PACKAGE TYPE: METAL ROUND

CERAMIC TOE UP 0°-4°

PLASTIC TOE DOWN 0°-4°

GLASS SEAL