

# fancort Industries, Inc.

31 FAIRFIELD PLACE

WEST CALDWELL, N. J. 07006

(973) 575-0610

WWW.FANCORT.COM

FAX (973) 575-9234

## FLAT PACK SPECIFICATION SHEET

FA NUMBER \_\_\_\_\_

CUSTOMER \_\_\_\_\_

PART NUMBER **T.I. 14 LEAD FP**

DATE \_\_\_\_\_

DRAWN BY FANCORT \_\_\_\_\_

CHECKED BY \_\_\_\_\_

PACKAGE TYPE

TOP BRAZE

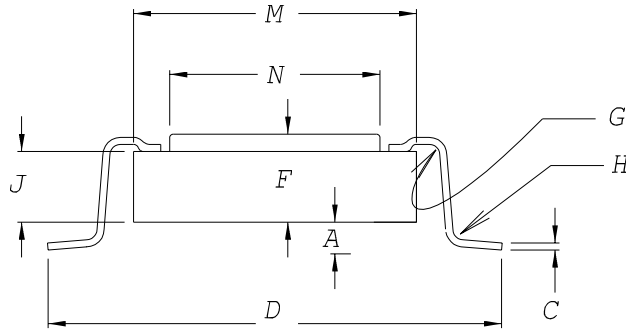

FOOT CONFIGURATIONS

SPRING BACK  
ANGLE 3°-7°

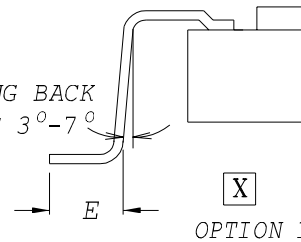

OPTION 1

SIDE EXIT

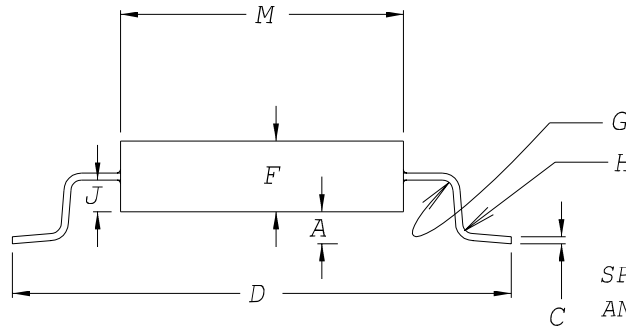

SPRING BACK  
ANGLE 3°-7°

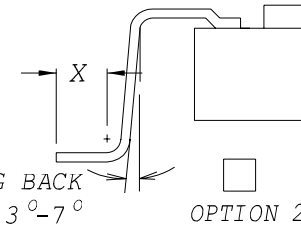

OPTION 2

JEDEC

BOTTOM EXIT

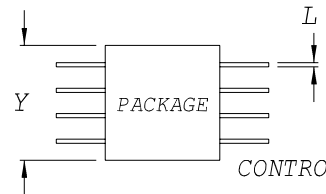
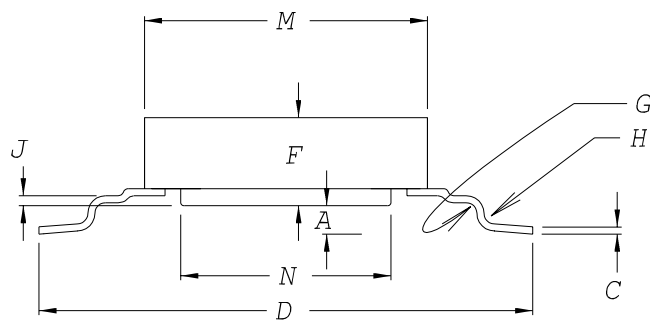

CUSTOMER SIGNATURE &  
DATE FOR ACCEPTANCE \_\_\_\_\_

CONTROLLING UNITS ARE [METRIC ] INCHES

LEADS TINNED  YES  NO

LEAD TYPE: FLAT

PACKAGE TYPE: METAL

ROUND

CERAMIC

TOE UP  0°-4°

PLASTIC

DOWN  0°-4°

GLASS SEAL

	DIM	TOLERANCE
A	.010	.002
C	.005	.001
D	.460	.010
E	.050	.005
OPTION 1		
OPTION 2		
F	.080	MAX
G	.010	.002
H	.010	.002
J	.035	.010
M	.260	MAX
N	-----	-----
PACKAGE LENGTH	Y	.390 MAX
LEAD WIDTH	L	.017 .002
PITCH		.050
# OF LEADS PER SIDE		7