

# fancort Industries, Inc.

31 FAIRFIELD PLACE

WEST CALDWELL, N. J. 07006

(973) 575-0610

WWW.FANCORT.COM

FAX (973) 575-9234

## FLAT PACK SPECIFICATION SHEET

FA NUMBER \_\_\_\_\_

CUSTOMER \_\_\_\_\_

PART NUMBER **S.T. MICRO 16 LEAD FP**

DATE \_\_\_\_\_

DRAWN BY FANCORT \_\_\_\_\_

CHECKED BY \_\_\_\_\_

PACKAGE TYPE

TOP BRAZE

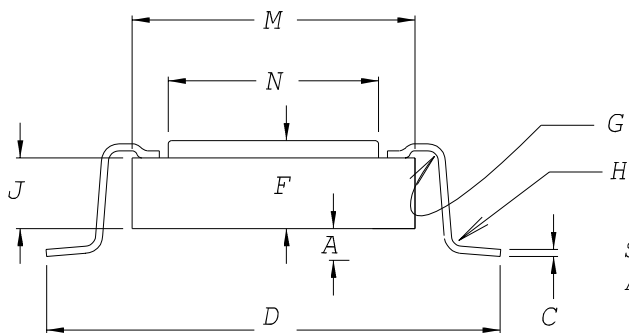

FOOT CONFIGURATIONS

SPRING BACK ANGLE 3°-7°

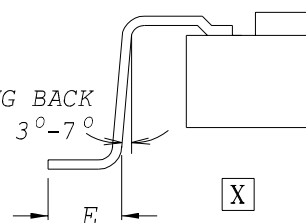

OPTION 1

SIDE EXIT

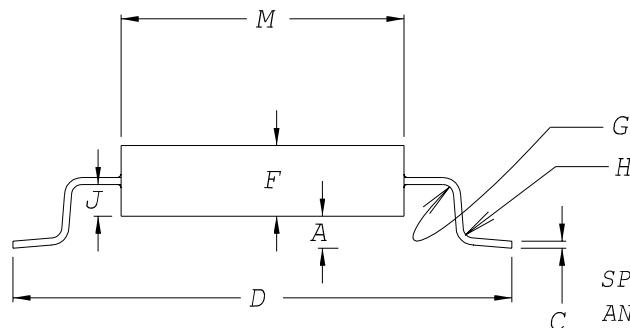

SPRING BACK ANGLE 3°-7°

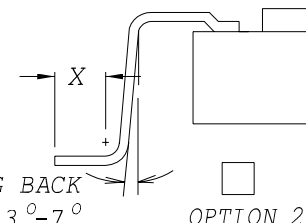

OPTION 2  
JEDEC

BOTTOM EXIT

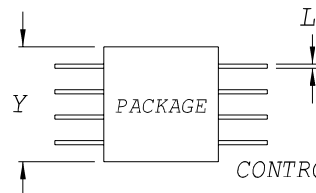
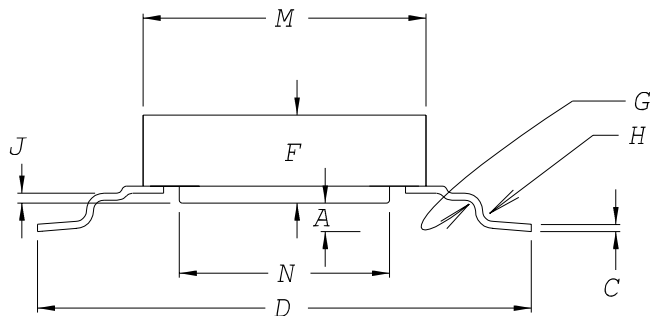

CUSTOMER SIGNATURE & DATE FOR ACCEPTANCE \_\_\_\_\_

CONTROLLING UNITS ARE [METRIC ] INCHES

LEADS TINNED  YES  NO

LEAD TYPE: FLAT

PACKAGE TYPE: METAL

ROUND

CERAMIC

TOE UP  0°-4°

PLASTIC

DOWN  0°-4°

GLASS SEAL

	DIM.	TOLERANCE	+/-
A	.010	.002	
C	.005	TYP	
D	.500	.010	
E	.050	.005	
OPTION 1			
OPTION 2			
F	.107	MAX	
G	.010	.002	
H	.010	.002	
J	.035	.010	
M	.272	TYP	
N	.170	TYP	
PACKAGE LENGTH	Y	.390	TYP
LEAD WIDTH	L	.017	TYP
PITCH		.050	
# OF LEADS PER SIDE		8	