

# fancort Industries, Inc.

31 FAIRFIELD PLACE

WEST CALDWELL, N. J. 07006

(973) 575-0610

WWW.FANCORT.COM

FAX (973) 575-9234

## FLAT PACK SPECIFICATION SHEET

FS NUMBER \_\_\_\_\_

CUSTOMER NASA

PART NUMBER 79C0408

DATE 4/25/07

DRAWN BY FANCORT BC

CHECKED BY \_\_\_\_\_

PACKAGE TYPE

TOP BRAZE

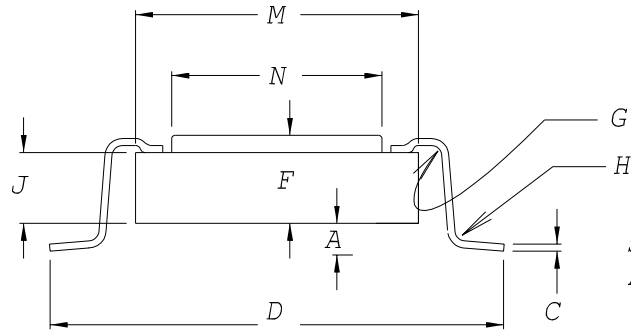

FOOT CONFIGURATIONS

SPRING BACK ANGLE  $3^{\circ}-7^{\circ}$

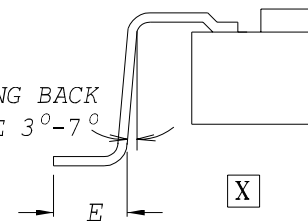

OPTION 1

SIDE EXIT

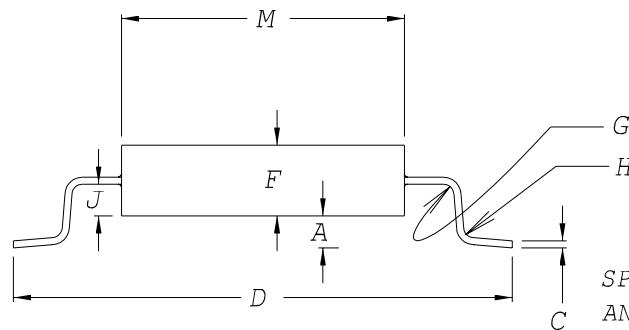

SPRING BACK ANGLE  $3^{\circ}-7^{\circ}$

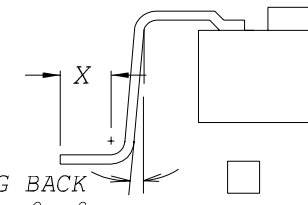

OPTION 2

JEDEC

BOTTOM EXIT

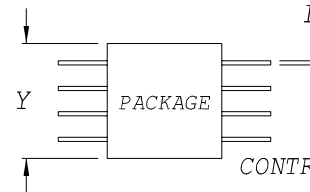
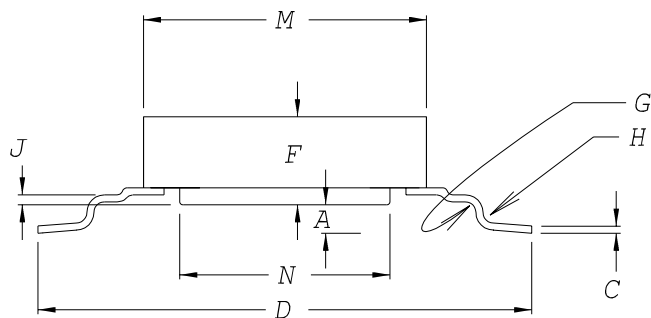

CUSTOMER SIGNATURE & DATE FOR ACCEPTANCE \_\_\_\_\_

CONTROLLING UNITS ARE [METRIC ] INCHES

LEADS TINNED  YES  NO

LEAD TYPE: FLAT

PACKAGE TYPE: METAL

ROUND

CERAMIC

TOE UP   $0^{\circ}-4^{\circ}$

PLASTIC

DOWN   $0^{\circ}-4^{\circ}$

GLASS SEAL

	DIM	TOLERANCE
	A	.020 .005
	C	.010 MAX
	D	1.250 .010
OPTION 1	E	.060 .005
OPTION 2	X	-----
	F	.300 MAX
	G	.012 .002
	H	.016 .002
	J	.270 MAX
	M	1.005 MAX
	N	.895 NOM
PACKAGE LENGTH	Y	.860 MAX
LEAD WIDTH	L	.022 MAX
PITCH		.040
# OF LEADS PER SIDE		20